

SILICONE CAULK IS RATED FOR EXPANSION JOINTS IN TRAFFIC AREAS

Exceeds Shore A Hardness Requirements

Expansion Joint – CEJ171

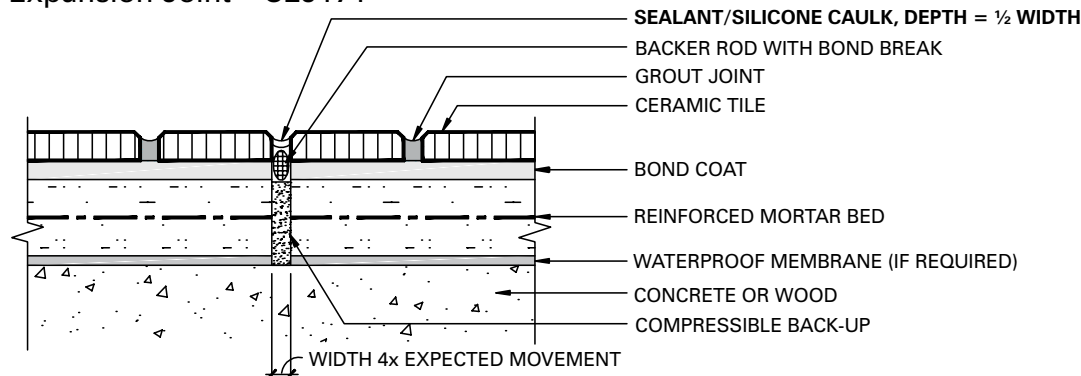

CUSTOM®'s Commercial 100% Silicone Caulk was developed for use as a caulk in coves, corners and changes of plane in interior, exterior or submerged applications. With 18 popular core colors (plus clear), this new caulk also meets the requirements for a movement joint sealant – ensuring a seamless tile or stone installation without a change of color in grout joints.

To ensure the longevity of large ceramic tile or stone installation, it is important that the installation is free to move horizontally with the subfloor. Stresses in the tile assembly can occur from thermal expansion and contraction, shrinkage of the curing concrete, or the flexing of suspended floors due to traffic. These forces can cause the tile to crack or lose its bond to the subfloor if the tile installation is not allowed to move with the substrate.

TCNA's Handbook mandates a soft movement joint every 20 – 25 feet (6 – 7.6 M) for interior installations, closer if exposed to sunlight and moisture, and every 8 – 12 feet (2.4 – 3.6 M) for exterior exposure installations (EJ171-09). These soft joints in the tile assembly and subfloor will absorb the damaging stress that would be transmitted to the tile. That's why it's important that movement joints in the subfloor be carried through the tile installation. Commercial 100% Silicone Caulk meets the requirements of movement joint sealant for commercial floors in traffic situations by meeting the requirements of ASTM C-920, ANSI and the TCNA Handbook.

Commercial 100% Silicone Caulk takes the place of the rigid cement grout over the movement joint in the subfloor. Since Commercial 100% Silicone Caulk has a high Shore A hardness (greater than the required 35) it is suitable for traffic

areas, as well as joints around the perimeter of the installation out of traffic paths.

Commercial 100% Silicone Caulk has distinct advantages over traditional urethane sealants, which are typically used in high traffic installations:

- ▶ Excellent resistance to most staining agents, so the joints won't attract dirt, requiring less maintenance.
- ▶ Excellent UV resistance, maintaining its color and elastic properties after years of exposure to weather. Urethane sealant can discolor and harden over time when exposed to UV rays/light.
- ▶ Achieves excellent bond strength to glass, non-porous, and glazed surfaces, making it the ideal product for installation between ceramic and porcelain tile.
- ▶ Shorter tack-free time (minimizing dust sticking to the surface) and shorter cure times (allowing for earlier traffic) than urethane sealants.
- ▶ Greater temperature service range (-60° F to 200° F [-51° C - 93° C]).
- ▶ Matches the core colors of Prism® SureColor® Grout, Polyblend® Grout and CEG-Lite™ 100% Solids Commercial Epoxy Grout, so designers have a consistent look across the entire tile installation; urethane sealants are generally available in only a few colors (i.e. white, gray, black, and tan).

The information in this bulletin is presented in good faith, but no warranty, express or implied, is given nor is freedom from any patent in as much as any assistance furnished by CUSTOM® with reference to the safe use and disposal of its products provided without charge. Custom® Building Products assumes no obligation or liability therefore, except to the extent that any such assistance shall be given in good faith.



Technical Bulletin
 Technical Services 800-282-8786
 custombuildingproducts.com