

FLOORS, INTERIOR

Concrete Subfloor – On or Above Ground

Unbonded Mortar Bed Installation of Ceramic or Natural Stone Tile

Service Rating – Extra Heavy (food plants, dairies, breweries, etc.)

TCNA Environmental Classification (Suitable for)

COM 1 – Dry Areas (i.e. floors, walls, ceilings of offices and hallways)

COM 2 – Limited Water Exposure (i.e. floors of bathrooms and locker-rooms)

COM 3 – Wet Areas (i.e. commercial kitchens, shower floors and enclosed pool areas)

COM 5 – High Temperature Areas (i.e. saunas and furnace rooms)

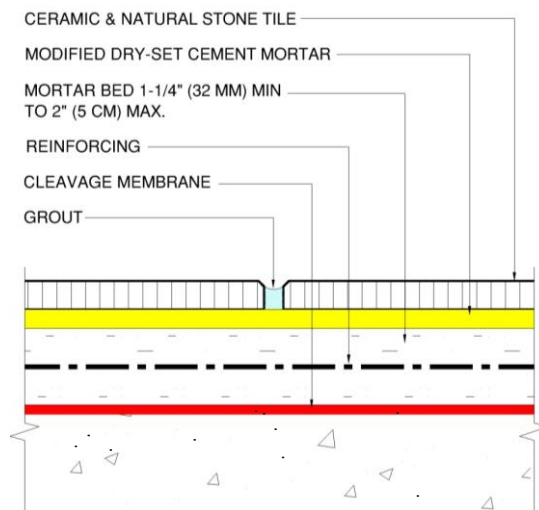

NOTE: Illustration shows the necessary components of the tile installation method, including the substrate. It has not been drawn to scale to clearly identify and label each component and its placement in the assembly.

Membrane Options:

- RedGard® Waterproofing and Crack Prevention Membrane (Liquid Applied) ANSI A118.10 & A118.12)

Mortar Options:

- MegaLite® Ultimate Crack Prevention Large Format Tile Mortar (ANSI 118.4TE, ANSI A118.15TE & ANSI A118.11)
- ProLite® Premium Large Format Tile Mortar (Ideal for Large Format Tiles) (ANSI A118.15)

Grout Options:

- Fusion Pro® Single Component® Grout* (Maximum Stain Resistance) (ANSI A118.7 & A118.3)
- Prism® Ultimate Performance Cement Grout (Shade and Efflorescence Control) (ANSI A118.6 & A118.7)

*For installations that may be exposed to staining, select tile and grout suitable for exposure.

*Refer to Technical Data Sheet for recommendations and instructions.

These drawings have been taken from Tile Council of America's (TCNA) Handbook for Ceramic Tile Installation and are also compatible with the drawings in Terrazzo, Tile and Marble Association of Canada's (TTMAC) Handbook. For your convenience, Custom Building Products options are substituted for TCNA's and TTMAC's generic product descriptions. Please refer to the handbooks for complete information.