

FLOORS, INTERIOR

Concrete Subfloor

Poured Gypsum Underlayment, Bonded, Anti-Fracture Membrane

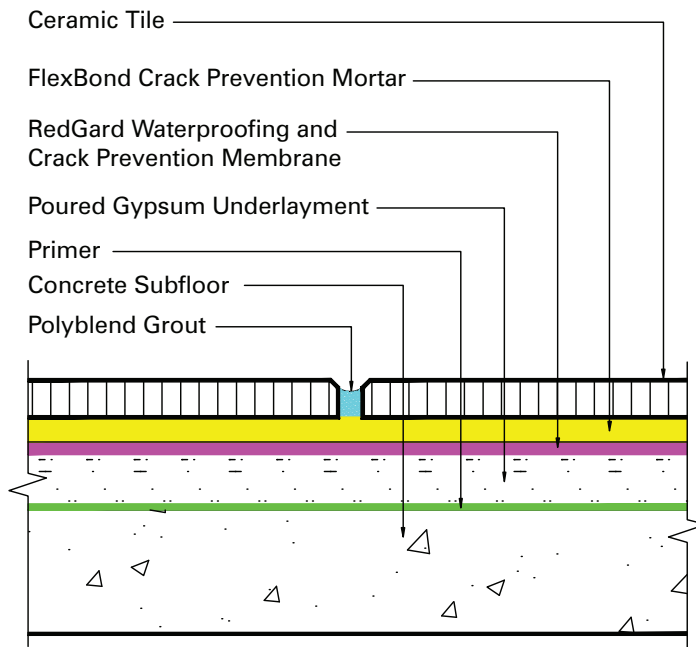

Qualifies for Lifetime Warranty

Poured Gypsum Flooring Compressive Strength must be Greater than 2000 psi.

Crack Isolation Membrane Options:

- RedGard® Waterproofing and Crack Prevention Membrane (Liquid Applied Membrane)
- Crack Buster® Pro Crack Prevention Mat Underlayment (Peel-N-Stick Membrane)
- EasyMat® Tile & Stone Underlayment (For Impact Sound Reduction)

Mortar Options:

- FlexBond® Crack Prevention Mortar (Flexible and Crack Isolation)
- Marble & Granite Fortified Premium Mortar (for Large Format tiles)
- MegaLite® Rapid Setting Crack Prevention Mortar (for Rapid Installation of Tile)

Grout Options:

- Polyblend® Grout (Polymer Modified Tile Grout)
- Prism® SureColor® Grout (Shade and Efflorescence Control)
- CEG-Lite™ 100% Solids Commercial Epoxy Grout (Stain and Chemical Resistance)

These drawings have been taken from Tile Council of America's (TCA) Handbook for Ceramic Tile Installation and are also compatible with the drawings in Terrazzo, Tile and Marble Association of Canada's (TTMAC) Handbook. For your convenience, Custom Building Products options are substituted for TCA's and TTMAC's generic product descriptions. Please refer to the handbooks for complete information.

